

OUR NEW COLLECTION  
BY ITALIAN DESIGNERS

STUDIO



PEPE

CARLO



DONATI



We noticed  
there are a lot of  
affinities with Italy  
here in Portugal,  
and that is very  
interesting, the  
passion for Wood's  
Craftsmanship,  
etching, and other  
materials as glass,  
ceramic and so on.



## STUDIOPEPE

---

After seeing the potential beneath the master artisans' skills, Chiara and Arianna found the right path to create a twist full design for the famous mid-century brands, Essential Home and DelightFULL.

A productive brainstorming gave wings to several ideas and possibilities the Italian designers believe that this task was the ultimate break to showcase their Made in Italy legacy and discover Portugal's strong craftsmanship techniques, like metalworking, wood carving, porcelain, hand-painted tiles, and jewelry manufactory. The ancient Portuguese crafts are a natural inspiration source for the Studiopepe's designers. Chiara fell in love with the traditional Portuguese metalworking techniques because this is a craft that can give to the product several original forms. On the other hand, despite her fascination for the magnificent forms and sculptural value, Arianna enjoyed the etching technic, a classic manufacture craft that evokes the past through its history.

"All of these elements stimulate us and we are curious to test it in the Design with a Contemporary Twist, and this is a positive challenge which motivates us a lot."  
– Ariana added.





After getting to know better the two mid-century brands by visiting the backstage scenario, the Italian designers were really amazed by the quality of products as well as the attention to detail and the fact all of their pieces are handmade by the best Portuguese master artisans. These three factors show that the two brands feature a strong character in every step of the designing process.

"It has been really interesting observing the employers at the factory, and their passion for Craftsmanship. We have been influenced by their passion because now we'll put them to the test." - said Arianna.

DelightFULL and Essential Home share the same design values from the start, that is why these two mid-century legends are always seen as the trendiest sister brands in the industry. "We loved 20s because they have been years which were discovered and designed many interesting things, also modern, but mostly only in 70s will be developed, ages that brought Innovations, that's why we have a kind of connection". Inspired by the most important components of mid-century lifestyles, such as music, fashion, and literature, the Italian based designers are lovers of the creative and modern concepts that these two luxury design brands bring to our days.

This union between the designer's talent and the brand's unique signature style is the perfect representation of the contemporary twist that Arianna and Chiara talked about before.



This year, the two Italian designers will be the thinkers and makers behind DelightFULL and Essential Home's mid-century products that will be a wonderland for the world's design lovers!

"Designing for Essential Home is a challenge I took up with enthusiasm because it gives me the opportunity to work on one of my favorite styles and moods which is the mid-century modern reloaded with new cues and materials."



We have the  
chance to  
add value  
toward what  
you already  
do, that is  
our value.



# Full Interview About Essential Home New Collection By Studiopepe

SEE NOW >



# HAPPY FEW COLLECTION

*THE REMARKABLE LAUNCH, 20 OCTOBER 2020*

## VIRGINIA ARMCHAIR

---

Softly padded and upholstered with the best high-quality velvet fabric, the mid-century modern armchair design features a gently laid-back structure on a molded shell, to provide style and comfort.







## **ZELDA SINGLE SOFA**

---

The unique Zelda single sofa truly challenges and redefines the limits of the new modern design perspective.

Featuring a generously rounded outline through its entire structure, the bespoke single sofa has a loop oversize backrest with a signature central fold surrounding a soft, organic seat. This unique mid-century modern furniture piece by Studiopepe provides the best of comfort and style in one single piece.



## FITZGERALD MODULAR SOFA

---

Rounded and oversized, with low backrest and a cockpit structure, Fitzgerald is the modular sofa of your dreams. Inspired by the shapes of Italian architecture, this piece proves art and interior design come together once you have the right eye for it.

Studiopepe brings their undeniably extensive experience into this sofa, giving us a piece that will be on everyone's minds. A brass shell hugs the sides and the lower part of the upholstery, giving it a defining structure that is hard to look away from.





## **FITZGERALD STOOL**

---

Following the same lines as the magnificent modular sofa, the Fitzgerald stool is the perfect decorative accessory to complete the look of your living room design. The padded stool features a brass shell that is embracing its soft rounded body, a unique detail that combines with the polished brass details on the rounded and oversized sofa design.



## **ISADORA DINING CHAIR**

---

If you're looking for an artistic furniture piece to match your luxury design project that has its own artistic personality, then Isadora is a piece that you need for your interior design.





## **EZRA DINING TABLE**

---

The Ezra Dining Table might be one of the most unique pieces in Studiopepe's collection for Essential Home. Inspired by the beautiful architectural lines of the iconic Italian scenario, the mid-century modern dining table was drawn from a combination of straight lines and circumferences, redefining the limits of physics and opening the world's design horizon.





## HENRY CHAIR

---

The three-legged upholstered chairs are handmade in solid wood and with soft, velvet upholstery. Although it only features three legs, unlike most chair designs, Henry provides the best stability and safeness to your interior design. It is the perfect way to add a modern twist to your interior room project while keeping things comfortable.



## PHILIP CENTER TABLE

---

Philip Center Table takes Ezra's challenging concepts of design and interprets them in an all-new and natural way. The structure of this magnificent center table turns around the different variations of the geometrical round shape and follows the unusual base idea of the fabulous dining table. The soft, organic shapes of the legs play with the geometric shapes of the travertine tops, highlighting the natural beauty of the high-quality materials that were used to handcraft the unique product.





## PHILIP SIDE TABLE

---

The Philip Side table is a simpler reinterpretation of the center table design, but with the same unique and inspiring flair. Its structure is also based on the geometrical round shapes, but it only features a solid base handcrafted in solid wood that supports a perfectly round table top made with travertine marble. This unique side table that challenges the standards of furniture manufacture can be considered as a solid representing the concept of balance in design since the delicate marble top is set on a round organic structure while maintaining its style and functionality.





## FRANCIS SCOTT SIDE TABLE

---

The Ezra Dining Table might be one of the most unique pieces in Studiopepe's collection for Essential Home. Inspired by the beautiful architectural lines of the iconic Italian scenario, the mid-century modern dining table was drawn from a combination of straight lines and circumferences, redefining the limits of physics and opening the world's design horizon.





## FRANCIS SCOTT OVAL SIDE TABLE

---

Simple and elegant, the Francis Scott side tables are a unique mid-century modern furniture piece that brings out the best of the minimalistic design approach.



## ERNEST SIDE TABLE

---

The Ernest side table features a geometrical and sculptural design made in metal with a straight line back. The front part is what adds another dimension to the interior design thanks to its well-defined layers. Its structure is inspired by the iconic lines of the Italian design and architecture landmarks.



## BEVERLEY SIDE TABLE

---

The Beverley side table features a unique sculptural design, made in travertine stone. Its structure is inspired by the iconic lines of the Italian design and architecture landmarks.

Featuring an artistic feel due to their inspiring structure, these unique furniture pieces can easily serve as the statement piece of your home décor, since they are the kind of piece you could find in a famous design exhibition of the world's top galleries. This unique piece can be handcrafted in wood or different metal finishes.





## DUNCAN SIDEBOARD

---

Mid-century style meets Italian excellence in a sideboard that defies the rules of design. Beauty and craftsmanship come together to provide you with a piece that will bring the 60s charm to the present.

The curved lateral metal structures of the sideboard support and hug the body of the cabinet, which is characterized by the geometric texture of the wood. High-quality materials and incredible craftsmanship skills make this an exceptional design piece you will need in your next design project or your home.



WELCOME TO MID-CENTURY LOVERS WORLD



SHOWROOMS WORLDWIDE: NYC | LONDON | MILAN | PARIS | MOSCOW | OPORTO  
ESSENTIALHOME.EU | INFO@ESSENTIALHOME.EU | +351 915 509 359 | @ ESSENTIAL\_HOME  
DELIGHTFULL.EU | INFO@DELIGHTFULL.EU | +351 914 922 036 | @ DELIGHTFULLL

 **ESSENTIAL HOME**  
MID-CENTURY FURNITURE

**delightFULL**  
Unique Lamps



## CARLO DONATI

---

Passionate about the lines of the mid-century design lines, Carlo Donati believes that this era was the period of a time period where elegance and lightness were reference points, so the inspiration for his new furniture collection wasn't hard to find. "I absolutely believe that it will be a fundamental reference in the luxury design since we're talking about timeless elegance." For the Italian designer, Essential Home is a brand that combines the Portuguese craftsmanship culture with a contemporary style.

For those who don't know, Portuguese craftsmanship has a well-known old tradition especially in relation to cork that is a light and resistant material and moreover an example of recyclable and sustainable energy. The hand-painted ceramic tiles and textile manufacturing are also a huge part of the country's artistic culture.

The Italian designer has grown up surrounded with one of the world's best craftsmanship cultures, so with this brand-new furniture collection, Carlo Donati could combine two of his many passions: craftsmanship and a modern approach of the mid-century style.



**Designing for  
Essential Home is  
a challenge I took  
up with enthusiasm  
because it gives me  
the opportunity to  
work on one of my  
favorite styles and  
moods which is the  
mid-century modern  
reloaded with new  
cues and materials.**

*CARLO DONATI*







According to Carlo Donati, this partnership was the perfect opportunity to combine the great tradition of the master artisans, through the finest Portuguese craftsmanship culture, with a more Mediterranean mood. His main goal with this mid-century collection was to introduce “lightness, sixties patterns, some kind of ‘joie de vivre’ – very Italian. Like the atmosphere in ‘La dolce vita’ – Federico Fellini’s masterpiece.” This is might be one of the most memorable collections ever created by the amazing Carlo Donati, don’t you think?

# LA DOLCE VITA COLLECTION

*THE REMARKABLE LAUNCH, 09 SEPTEMBER 2020*



---

Carlo Donati went live on Instagram to tell some interesting details on his most recent works. Discover with us why the Italian legend says its unique new pieces are closely related to Italy's most famous architecture icons!

Referencing the inspiring design concepts of the post-war period, that was marked by iconic personalities, like Gio Ponti and Franco Albini, the Carlo Donati Studio combined forces with one of the top mid-century furniture brands to create a memorable collection that combines style, high-quality material, fine craftsmanship techniques with a touch of history.

The incredible Carlo Donati has revealed some interesting details about his brand new mid-century collection with Essential Home in his inspiring Instagram Live! The new mid-century modern collection by Carlo Donati and Essential Home combines the best of both worlds, or in this case, inspirations: great Italian architecture and design legends as well as a representation of Palm Springs mid-century modern architecture and design culture.

**SEE MORE >**

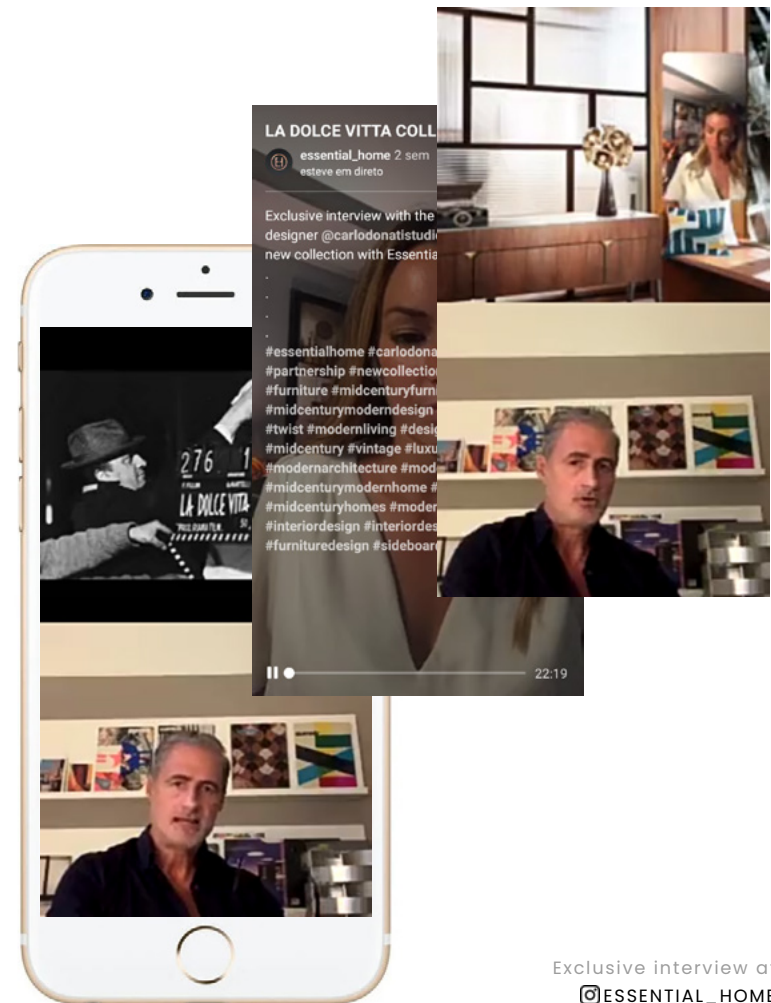

Exclusive interview at  
 ESSENTIAL\_HOME

## FEDERICO DINING CHAIR

---

These unique fifties patterns are also found in the luxurious upholstery of the Federico chair design, paired with the ivory back seats. This beautiful piece is a tribute to the great Federico Fellini, one of the best Italian film directors and screenwriters, known for his distinctive style, a mix of fantasy and baroque images with dreadfulness.







## ALBERTO DINING TABLE

---

Named after one of the best Italian cinema personalities (Alberto Sordi), the smooth curvilinear lines of the wooden legs of this unique table design take inspiration from the architectural shapes of Oscar Niemeyer's concrete structures.





## VITTORIO SIDEBORD

---

These same curvilinear lines are found in the sophisticated design of the Vittorio sideboard, named after the great Vittorio Gassman. The combination of the wooden black lacquered H shaped legs with a walnut wood body and recessed golden handles, recall the lines of a blooming flower.



“Where old school  
meets modern”



## MINA SUSPENSION

---

Inspired by the Turin's beautiful Palazzo del Lavoro by Pier Luigi Nervi and Gio Ponti, this unique suspension embodies a look of a stylized plant with a round-shaped heart with the arms that rise like gilded branches.



## CLAUDIA RUG

---

Named after the iconic Claudia Cardinale, this luxury piece embodies an unexpected selection of wool colors, connected with rust, light blue, and sand powder palette. Embracing a fluid line design, this high-end rug design was handcrafted by the best Portuguese master artisans.





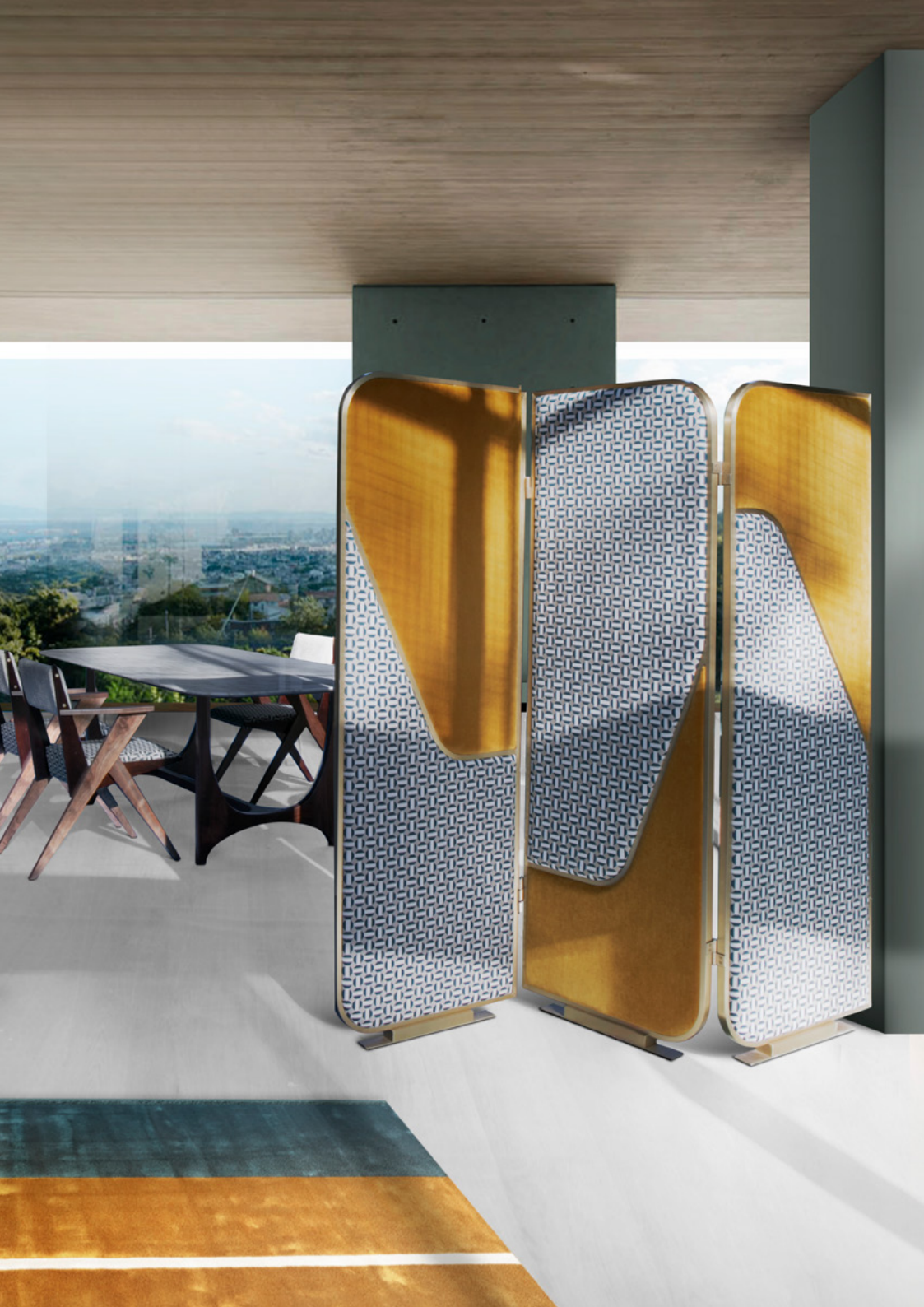

## GIULIETTA SCREEN

---

The precious crossing curved brass frame of this beautiful screen, named after Giuletta Masina, creates an elegant dialogue with the upholstery, deep yellow or peacock velvet combined with a fifties taste fabric.







## ABOUT ESSENTIAL HOME

---

Essential Home sees this style as a stylish sanctuary from the stresses of life.

In interior design, it's all about respect for history, you should bring together the iconic character and elegance of the space with practical luxury. But Paris as it's fun and magic side, and Parisienne style is that whole idea of anti-decor, always have to look like you've done it yourself like a true French.

What better way to represent them to mix our soft and clean Marco Dining chair with the robust and sturdy Bertoia marble table. The key is to keep it simple, mixing vintage with new, and allow our memories and treasures brought home from travels to shape the space rather than sticking to any particular interior Style.