

## Behind the scenes

## About TreCe

TreCe started in the 1970s - and has since then worked purposefully to become one of the leading suppliers of storage furniture for the office and public environment in Scandinavia.

Today we have reached that goal. Our products have also become interesting for other parts of the world. We supply to several countries in Europe, Asia and North America.

Design, function and sustainability are important to us and we are really proud of the products we offer the market. All the knowledge that we have built up within the company regarding storage and recycling has made us experts in these areas.

The key for us is that our products have a low environmental impact and exceptional functionality. All this without compromising on the design, which is also an important part of the user perspective. We have chosen to call this "Smart Design".

In recent years, our recycling products have also become winning concepts. Several of our products have won international awards for innovative design and function.

## About sustainability

We feel a major responsibility for the environment and contributing towards a more sustainable world. Therefore, we place great importance on developing products with low environmental impact and lasting quality that are responsibly made with care. We want to make it easy for our customers to make sustainable choices.

### **How does TreCe work to reduce the impact on the outside world from our products?**

Sustainability is in our business DNA, woven into products from the drawing board to end use. The aspects of sustainability are our framework. Materials, design, production, component origin, information, suppliers etc. are examples of the aspects we work from. Transparency throughout the supply chain is crucial, and we only work with partners that share our vision. By raising an awareness we can promote and encourage sustainable sourcing.

A key factor for progress is curiosity and being open to new solutions like changing to recycled materials, design for circular economy, fewer components etc. We have begun an exciting journey filled with possibilities.

### **Labels and certificates**

TreCe has chosen to work with the labeling system Möbelfakta that has criteria in quality, environment and social responsibility. Our approved furniture has undergone extensive testings, is produced according to ethical guidelines and has been made according to the environmental requirements. In short Möbelfakta is a guarantee of a high quality product.

Along side we have environmental declarations that list components and materials, the production stage and how the furniture should be recycled.

Our organization is certified to ISO 14001:2015 and ISO 9001:2015, and has been for many years.

## About working together

Our customers' opinions are important to us, because they give us valuable insights into which products we need to develop to meet the market demand. When we start a project we listen and investigate what needs exist and develop a plan to solve them together. By working together, we can make sure that our customers' thoughts and ideas are included from the first call to the completed project.

### **Storage experts**

We share all our knowledge with our customers. Whether the focus is flexibility or smart solutions, big or small scale, with our expertise we create optimal storage solutions that work today and tomorrow.

Please contact us for a presentation, to learn more about how we can create a working solution together.

# Cloud recycling

Design | Ebba Hellberg and Sigrid Ljungström



**Cloud** is a mobile recycling unit designed to fit into a modern work environment where flexibility and aesthetics are two key factors. This is reflected in the simple and classy design with the characteristic rounded corners and the bold castors that invite you to move Cloud around.

Cloud has won first prize in the German Design Award 2019, Excellent Product Design in the category office furniture/environment sorting.



**Width Cloud 2:** 787 mm, 31" | **Width Cloud 3:** 1172 mm, 46.1" | **Frame:** Lacquered MDF, thickness 16 mm, 0.63" – 11 standard colors or MFC, thickness 16 mm, 0.63" – Light gray (U12188) or Anthracite (U12011) | **Height:** 1090 mm, 42.9" | **Doors:** Powder coated steel, thickness 0.12" – 11 standard colors (RAL) | **Depth:** 500 mm, 19.7" | **Capacity/castor:** 80 kg, 176.3 lbs. Black castors with rubber surface. Two of the castors have breaks, and all are turnable. Castor height: 100 mm, 3.9". | Three white pull-out sack holders are included, fits 85-125 liter, 22.5-33 gallon bags



# Birdie recycling

Design | Studio Doms

**Birdie** is a flexible recycling piece made of resistant Swedish steel. Available in 11 standard colors and delivered with specially designed symbols for easy sorting.

Birdie is available in two sizes and holds 43 liters, 11.4 gallons (Birdie 500) and 63 liters, 16.6 gallons (Birdie 700), both have soft closing lids. Inlet/ring is made of stable quality plastic and is labeled for recycling according to ISO 11469.

Birdie consists of Swedish steel of which 20 % is recycled material, and lacquered with powder coating, which lowers the environmental impact on the product.



**Floor:** Width: 410, 910, and 1410 mm, 16.1", 35.8", 55.5" | Height: 916 mm, 36" | Depth: 400 mm, 15.7" | Frame in powder coated steel | **Wall:** Width: 410 mm, 16.1" | Height: 613 and 863 mm, 24.1" and 34" | Depth: 500 mm, 19.7" | Lid in powder coated aluminum | Inlet/ring in plastic, marked according to ISO 11469 | Inlet/ring removable for cleaning, dishwasher safe

# Kite recycling

Design | Annica Doms



**Kite** is a modular recycling unit designed by Annica Doms. Awarded the Red Dot Design Award 2012 and first prize in the German Design Award 2019.



reddot design award  
winner 2012



The frame is made of shock-resistant powder coated sheet steel that consists of 20% recycled materials and is available in all RAL colors. Lid in environmentally friendly vacuum foiled MDF. Designed for modularity in different configurations.

Lid in seven different versions with various cut-outs and screen printed symbols for different types of waste. Adapted for standard bag of 85-125 liters.

Kite RAW



**Width:** 500 mm, 19.7" | **Height:** 700 mm, 27.6" | **Depth:** 492 mm, 19.4" | Frame is made of shock-resistant powder coated steel | Lid in a vacuum foiled MDF, screen-printed symbol.



# Kite mini Recycling

Design | Studio Doms

**Kite mini**, has taken its name as well as its appearance from the geometric form of a kite.

The straight angles give a bold and exciting expression, and at the same time harmonize with the room and its shape. The unique form holds angles of 60 °, 90 ° and 120 ° which makes it ideal to place in corners with varying angles.



Kite mini builds on the same form and is an exact copy of Kite, but in a reduced size. This gives a clear "family feeling" and a uniform expression. Kite mini is intended for smaller spaces like under desks, hotel rooms or smaller conference rooms.

There is also a wall mount for the Kite mini, which means that it can be placed on the wall - as single or in pairs to free floor space.



**Width:** 250 mm, 9.8" | **Height:** 355 mm, 13.9" | **Depth:** 245 mm, 9.6" | **Frame:** Made of shock-resistant powder coated steel (10L volym). | **Lid:** In white or anthracite. Vacuum foiled MDF with screen printed symbol. | **Base:** ABS plastic made from 100% recycled material. | **Wall mount:** Right or left. Wall mount is included in Kite mini wall.



# Hold Recycling

Design | Tengbom



**Hold** - TreCe, together with Tengbom architects, have developed the recycling bin Hold.

A collaboration that started with Tengbom seeing a need for a different and functional recycling bin that could meet the needs of smaller spaces. Conference rooms, hotel rooms, smaller meetingrooms, etc. TreCe was contacted and the result was Hold.

A small and functional bin with a lid that is available in 7 different profiles. There is also a wall mount for Hold, which means that it can be placed on the wall.

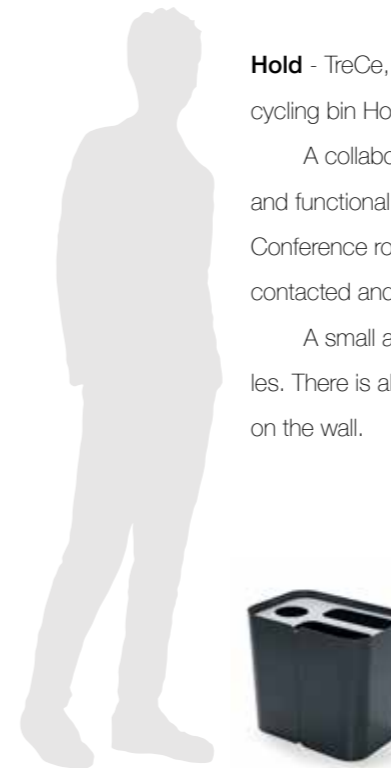

**Width:** 340 mm, 12.6" | **Height:** 300 mm, 11.8" | **Depth:** 230 mm, 9.1" | **Frame:** 1 mm powder coated sheet metal | **Lid:** 1.5 mm powder coated sheet metal | **Lid profiles:** 7 hole profiles with clear text for each fraction | **Container bin:** 100% recycled plastic, dishwasher safe



# Ridge Recycling

Design | Studio Doms

NEWS!



**Ridge**, with its special expression, becomes a different and expressive feature in the modern office. It gives the impression of an interior detail, not just an recycling station.

A very stable construction that is built of 22 mm MDF and lacquered in 11 standard colors. Stainless steel ramp for easier access of a 140 liter container is not only a practical detail, but also a design-prominent part. Ridge is available in two heights. The difference between Low and High is the slope of the upper part of the frame. Ridge can be ordered with 8 different symbols, depending on the purpose.



**Width:** 600 mm, 23.6" | **Height:** Ridge High: 1521 mm, 59.8"; Ridge Low: 1397 mm, 55" | **Depth:** 650 mm, 25.6" | **Bottom/Gables/Tops:** 22 mm lacquered MDF | **Door/Back:** 16 mm lacquered MDF | **Plates/scratch protection door/loading ramp:** all in stainless | **Rubber mat:** Included | **Adjustable feet** | **Sackholder:** In stainless steel | **Doors** with aximate hinges.



# Sail clothes stand

Design | Studio Doms



Clothes stand in lacquered steel for several types of hanging – traditionally on knobs, hanging over the rods or with the help of a hanger.

Sail is laser cut and has no welding joints. Available in 11 selected RAL colors with accentuating knobs in brass. Sail is also available as wall hung with brackets in the same RAL color.

Floor standing Sail arrives in two parts, wall mounted Sail is delivered in one piece with wall mount brackets. Both in a flat package and are easy to assemble.



Accentuating knobs in brass.



Sail is laser cut and has no welding joints.

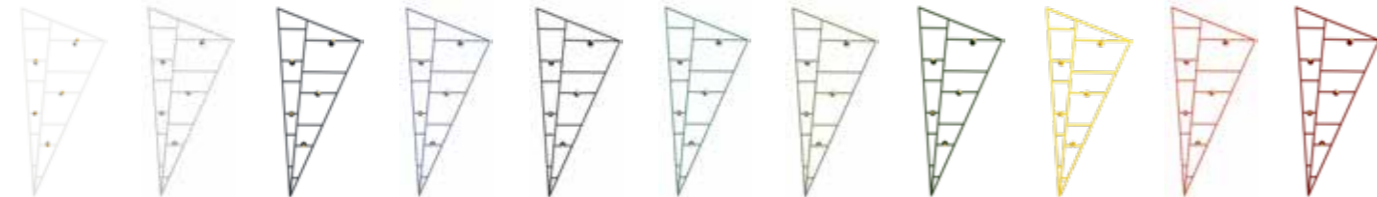

Pure white RAL 9010 | Light Gray RAL 7035 | Anthracite RAL 7016 | Pigeon blue RAL 5014 | Gray blue RAL 5008 | Mint turquoise RAL 6033 | Pale green RAL 6021 | Chrome green RAL 6020 | Yellow RAL 1021 | Salmon pink RAL 3022 | Wine red RAL 3005

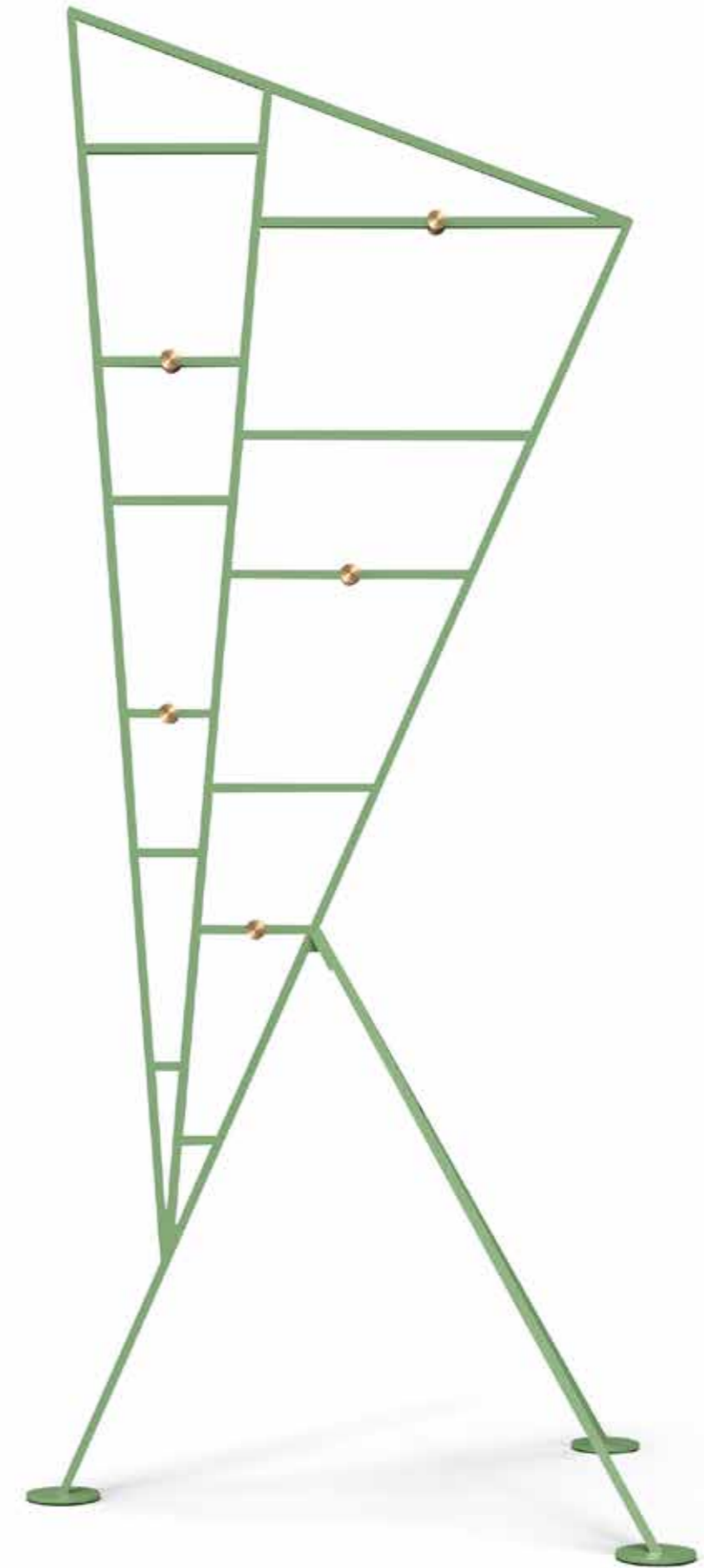

**Sail:** 777 x 1812 x 822 mm, 30.6" x 71.3" x 32.4" | **Sail wall:** 689 x 1532 x 158 mm, 27.1" x 60.3" x 6.2" | Powder coated steel | Knobs in brass | Laser cut and has no welding joints.

# Soft media unit

Design | Studio Doms



Storage piece in white pigmented ash veneer or white lacquered MDF. Both models have the same high-quality finish on all sides and comes with sturdy legs stands in white pigmented solid ash.

Made from carefully selected materials with a low environmental impact where all wood material is traceable. See variants on two, three and four storage units. All units are prepared for media storage, with outlets for cables and ventilation.



Prepared for media storage, with outlets for cables.



Soft has a drawer in the drawer for a clean outside and a functional inside.



Distance between door and frame for ventilation.

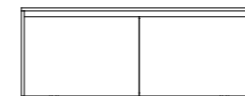

Soft 2x60, door/door 1246x466x497  
Soft 2x60, door/drawer 1246x466x497

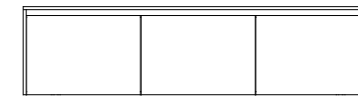

Soft 3x60, 2 doors/1 drawer 1851x466x497

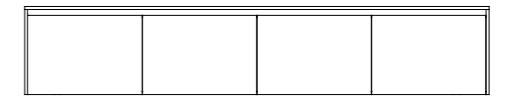

Soft 4x60, 3 doors/1 drawer 2456x466x497



Soft frame 2 massive ash 942x300x376



Soft frame 3 massive ash 1547x300x376



Soft frame 4 massive ash 2152x300x376

**Width:** 1246, 1851 and 2456 mm, 49", 72.9" and 96.7" | **Height:** 466 mm, 18.3" | **Depth:** 497 mm, 19.6" | **Fronts** in white pigmented ash veneer or white lacquered MDF (0500 N)

**Inside,** both options of Soft have a white ash melamine structure (Egger W1000 ST22) | **Legs** in white pigmented solid ash.

# Place shelving system

Design | Studio Doms

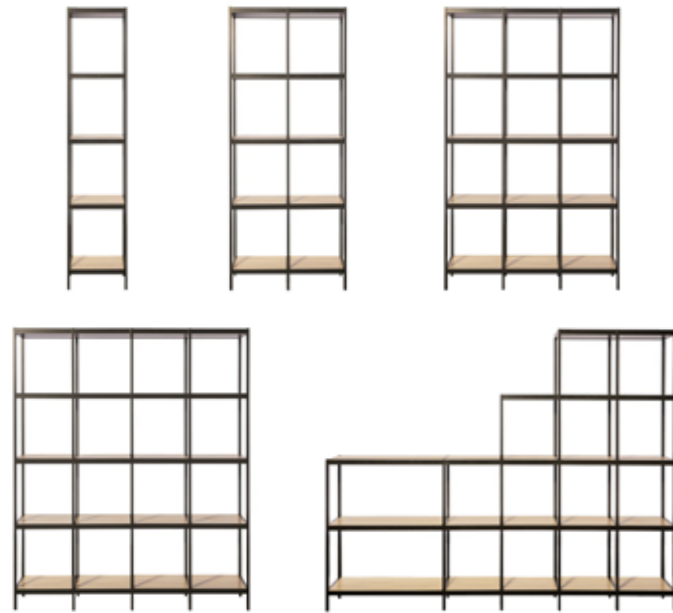

Open shelf system for room division and storage. Frame of dark gray powder-coated aluminum with shelves in light ash with brass detail.

Place is a shelving system with endless combination possibilities that can be easily tailored to your specific needs.

Place is available in two shelf widths (361 and 739 mm, excluding end gables) and three different heights (1003, 1433 and 1863 mm) that can be easily assembled and adapted as needed. As a step in TreCe's continuous environmental work, Place is delivered in flat packages.

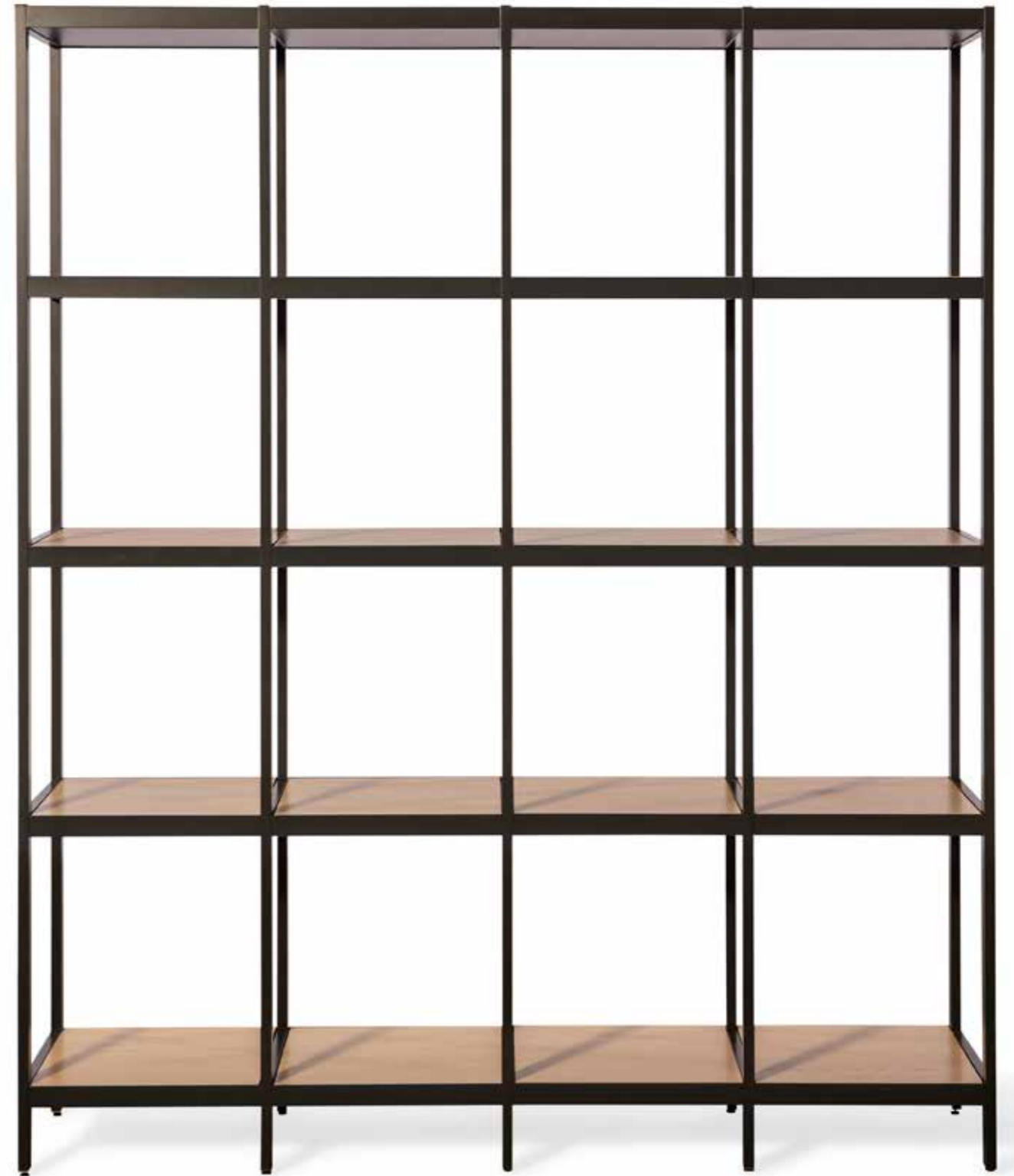

**Width:** 361 and 739 mm (excluding end gables), 14.2" and 29" | **Height:** 1003, 1433 and 1863 mm, 39.5", 56.4" and 73.3" | **Depth:** 395 mm, 15.6" | **Frame:** Made of dark gray powder coated aluminum, and brass details | **Shelves:** Bearing shelves in anthracite laminate with decor shelf, thickness 1.4" | **Decor shelf:** Decor shelf light ash, thickness 0.2".

# CombiLine storage

Design | TreCe



**CombiLine** is a space-efficient cabinet that make use of all square and cubic meters in the office. Available as standard in white, beech, birch and oak.



Or you can choose freely among all NCS colors. Approved according to Möbelfakta, a sustainable choice for the environment, made with social responsibility and quality tested. Standard widths: 310 mm, 605 mm, 800 mm and 900 mm.



# Space storage

Design | TreCe

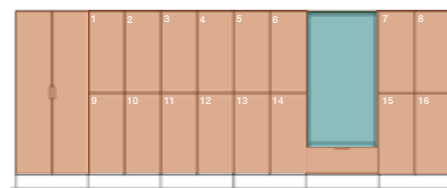
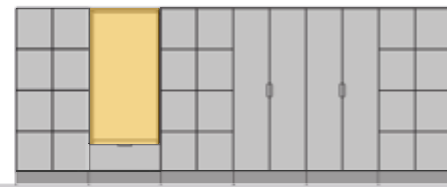
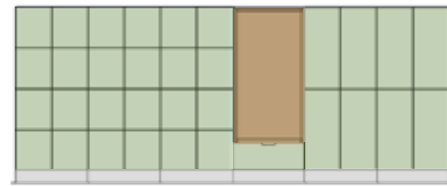
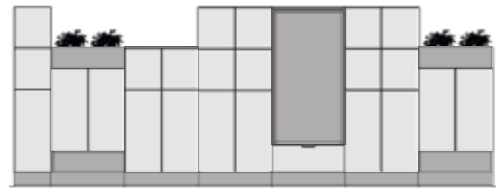

**Space** is a flexible storage series that invites to creative and unique solutions tailored to the everyday needs. Doors with full-surface design in MDF as standard, choose any NCS color after taste and preferences.

The frames are also available in any NCS. Choose between three frame heights and two door heights.



Let your imagination flow and build your unique solution. Doors are available with cabinet locks (incl. 2 keys), padlock fittings (excl. padlock) combination locks or RFID locks.

Give life to storage with custom designed accessories such as adjustable shelves, clothes rails, mirror, hooks, carpets, cork box Stuff and Office products. Approved according to Möbelfakta, a sustainable



choice for the environment, made with social responsibility and quality tested.

- Optional NCS color
- Doors in full-cover design
- Integrated power inlets for charging laptops/mobile phones
- Custom designed accessories

# Office family bag, backpack, pouch and sleeve

Design | TreCe

**Office Family** for those who want a bag, backpack, sleeve or a pouch that works both around and outside the office. Now you can organize, store and move your office supplies and laptop with Office Family. Made from needled polyester felt with 7% wool, and with details in leather. The felt meets Oekotex 100, class I.

Office Bag



Office Backpack



Office Pouch



Office Sleeve



**Office bag:** WxDxH. 360 x 170 x 310 mm, 14.2" x 12.2" x 6.7" | Needed polyester felt with 7 percent wool and with genuine leather details | **Inside:** A divider in the middle, pen holder (leather) and accessory pocket, Business card holder in front of the bag (leather) Practical shoulder strap.

**Backpack:** WxDxH. 310 x 135 x 400 mm, 12.2" x 5.3" x 15.7" | Top opening, Foldable flap, Handles, Magnetic closure with 2 positions, hidden in the lining, Business card holder in leather, Adjustable shoulder straps with details in leather, Push buttons on the side for adjusting the depth, Water resistant bottom, Integrated rain cover hidden in the bottom with zipper. **Inside:** Holds 15L, Laptop compartment, Pen holder in leather for 3 pens. Pocket for accessories

**Computer sleeve S:** Fits 13.3" WxH: 250x360 mm, 9.8" x 14.2" | **Computer sleeve M:** Fits 13.3"-14.5" WxH: 280x400 mm, 11" x 15.7" | **Computer sleeve L:** Fits 14.5"-15.6" WxH: 310x440 mm, 12.2" x 17.3"

**Office pouch:** WxDxH: 175x160x50, 6.9" x 1.9" x 6.3" | Needed polyester felt with 7 percent wool and with details in genuine leather. Available in colors anthracite and light gray.

For more information about us, our products and their sustainability, visit our website [www.trece.se](http://www.trece.se) or our showrooms in Norrköping, Stockholm and Oslo.



**Norrköping / Head office / Showroom**  
Importgatan 39  
P.O. Box 6063, SE-600 06 Norrköping  
Tel +46 11 21 14 80  
[info@trece.se](mailto:info@trece.se)  
[www.trece.se](http://www.trece.se)

**Stockholm / Showroom**  
R40 Center  
Rosenlundsgatan 40  
Tel +46 11 21 14 80

**Oslo / Showroom**  
Studio Thune  
Drammensveien 130 B13, Skøyen  
Tel +47 23 96 07 22