

Piatto doccia da rivestire in technoPVC  
Showertray to be clad in technoPVC

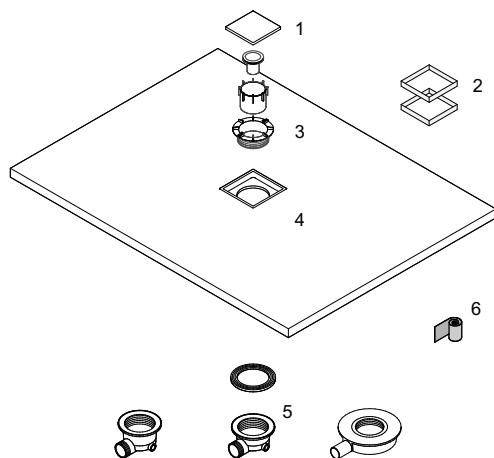

- |   |                                      |   |                                   |
|---|--------------------------------------|---|-----------------------------------|
| 1 | copriscarico in technoPVC standard   | — | waste cover in technoPVC standard |
| 2 | copriscarico in acciaio inox (opz.)  | — | waste cover in stainless steel    |
| 3 | ghiera fissaggio piletta             | — | waste fixing ring                 |
| 4 | basic shower                         | — | basic shower                      |
| 5 | piletta h.5,0/6,0/8,0cm              | — | waste H 5,0/6,0 / 8,0 cm          |
| 6 | nastro impermeabile butilico adesivo | — | waterproof adhesive butyl seal    |

PESI / WEIGHTS :

X	Y	H
80	80	4
100	100	4
120	120	4
140		4
160		5
180		5
200		5
220		5
240		5

piatto doccia: 5,90 kg/m<sup>2</sup>  
shower tray: 5,90 kg/m<sup>2</sup>

X - Y a misura su richiesta / bespoke upon request  
Y a richiesta fino a 150 cm / Y on request up to 150 cm

**COLLANTI / GLUES :**  
**MAPEI KERALASTIC / KERAKOLL H40 EXTREME o similari**  
**direttamente su technoPVC / directly on the technoPVC.**

Nel caso si utilizzino collanti diversi o rivestimenti in cemento-resina è necessaria l'applicazione di Primer.  
In case different glues are used or cement/resin claddings are applied, the use of a Primer is mandatory.

PER INFORMAZIONI DI POSA VEDERE SCHEDA DI INSTALLAZIONE.  
Should you need any information about the products' installation, please rely on the instructions provided.

**ATTENZIONE:** Collaudare il piatto doccia prima della posa dei rivestimenti/resinatura.  
**CAREFULL:** Test the shower tray before laying the finishing/resin.

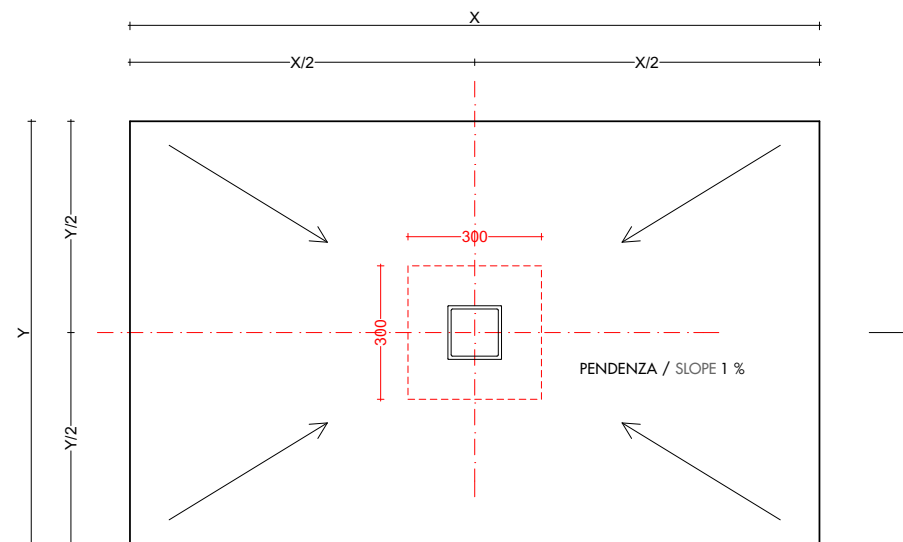

PILETTA SIFONATA H 60 mm / ingombro totale 65 mm -- portata 24 lt/min  
WASTE WITH SIPHON H 60 mm / total height 65 mm -- flow rate 24 lt/min

PILETTA SIFONATA H 80 mm / ingombro totale 85 mm -- portata 31 lt/min  
WASTE WITH SIPHON H 80 mm / total height 85 mm -- flow rate 31 lt/min

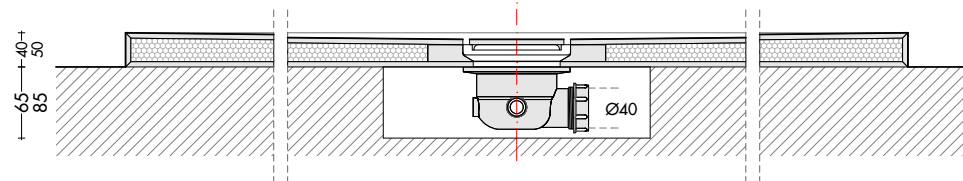

PILETTA SIFONATA H 50 mm (sifone ridotto) / ingombro totale 55 mm -- portata 31 lt/min  
WASTE WITH SIPHON H 50 mm (reduced siphon) / total height 55 mm -- flow rate 31 lt/min

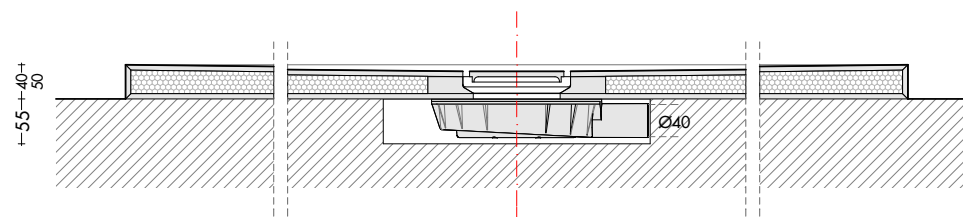

# BASIC SHOWER PLUS\_Appoggio Floorstanding

## 1 bordo tipo B 1 edge type B

Piatto doccia da rivestire in technoPVC  
Showertray to be clad in technoPVC

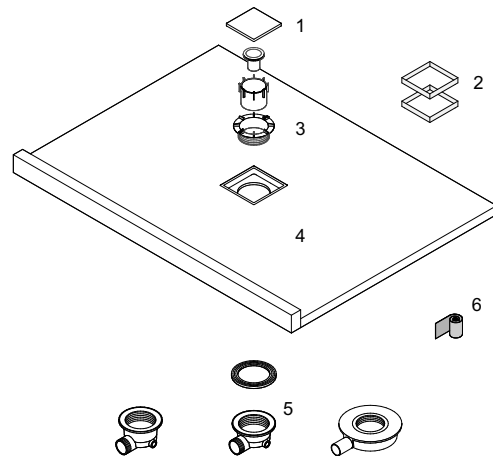

- |   |                                      |   |                                   |
|---|--------------------------------------|---|-----------------------------------|
| 1 | copriscarico in technoPVC standard   | — | waste cover in technoPVC standard |
| 2 | copriscarico in acciaio inox (opz.)  | — | waste cover in stainless steel    |
| 3 | ghiera fissaggio piletta             | — | waste fixing ring                 |
| 4 | basic shower                         | — | basic shower                      |
| 5 | piletta h.5,0/6,0/8,0cm              | — | waste H 5,0/6,0 / 8,0 cm          |
| 6 | nastro impermeabile butilico adesivo | — | waterproof adhesive butyl seal    |

### DIMENSIONI / DIMENSIONS :

X	Y	H
80	80	4
100	100	4
120	120	4
140		4
160		5
180		5
200		5
220		5
240		5

### PESI / WEIGHTS :

piatto doccia:	5,90 kg/m <sup>2</sup>
shower tray:	5,90 kg/m <sup>2</sup>
bordo:	1,20 kg/ml
edge:	1,20 kg/ml

X - Y a misura su richiesta / bespoke upon request  
Y a richiesta fino a 150 cm / Y on request up to 150 cm

### COLLANTI / GLUES :

MAPEI KERALASTIC / KERAKOLL H40 EXTREME o similari  
direttamente su technoPVC / directly on the technoPVC.

Nel caso si utilizzino collanti diversi o rivestimenti in cemento-resina è necessaria l'applicazione di Primer.  
In case different glues are used or cement/resin claddings are applied, the use of a Primer is mandatory.

### PER INFORMAZIONI DI POSA VEDERE SCHEDA DI INSTALLAZIONE.

Should you need any information about the products' installation, please rely on the instructions provided.

ATTENZIONE: Collaudare il piatto doccia prima della posa dei rivestimenti/resinatura.  
CAREFULL: Test the shower tray before laying the finishing/resin.

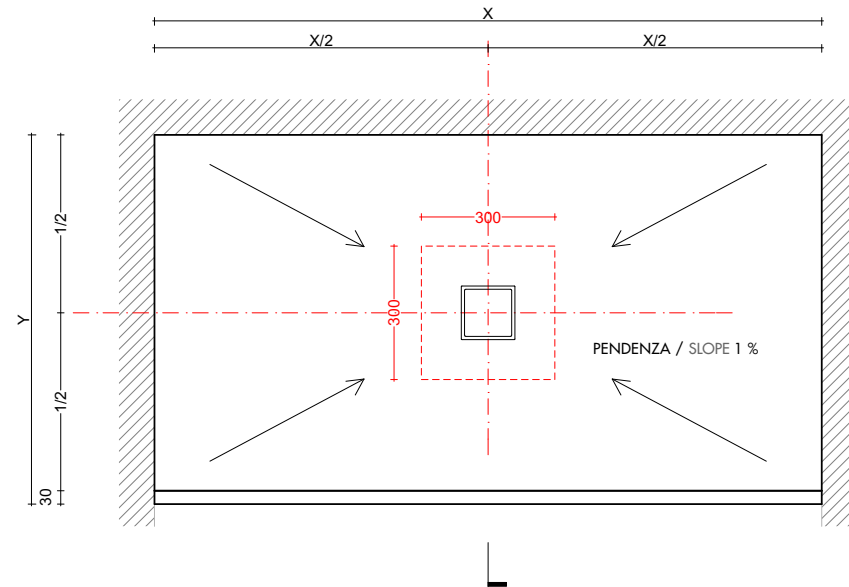

PILETTA SIFONATA H 60 mm / ingombro totale 65 mm -- portata 24 lt/min  
WASTE WITH SIPHON H 60 mm / total height 65 mm -- flow rate 24 lt/min

PILETTA SIFONATA H 80 mm / ingombro totale 85 mm -- portata 31 lt/min  
WASTE WITH SIPHON H 80 mm / total height 85 mm -- flow rate 31 lt/min

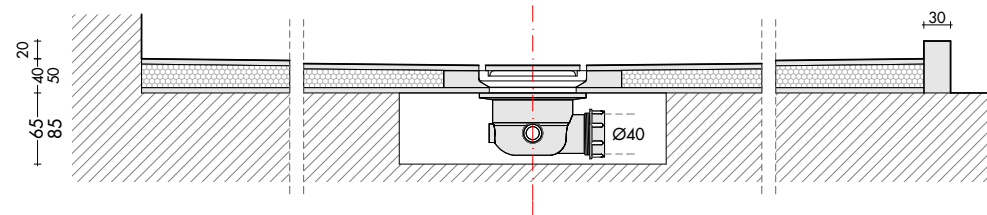

PILETTA SIFONATA H 50 mm (sifone ridotto) / ingombro totale 55 mm -- portata 31 lt/min  
WASTE WITH SIPHON H 50 mm (reduced siphon) / total height 55 mm -- flow rate 31 lt/min

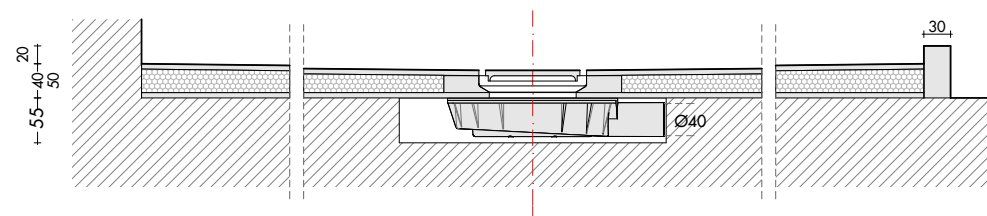

# BASIC SHOWER PLUS\_Appoggio Floorstanding

## 2 bordi tipo B 2 edges type B

Piatto doccia da rivestire in technoPVC

Showertray to be clad in technoPVC

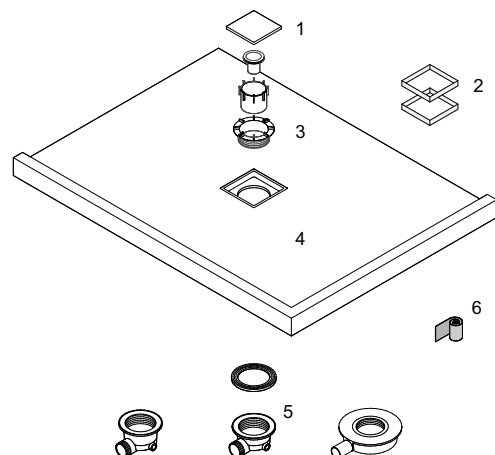

- 1 copriscarico in technoPVC standard
- 2 copriscarico in acciaio inox (opz.)
- 3 ghiera fissaggio piletta
- 4 basic shower
- 5 piletta h. 5,0/6,0/8,0 cm
- 6 nastro impermeabile butilico adesivo

- waste cover in technoPVC standard
- waste cover in stainless steel
- waste fixing ring
- basic shower
- waste H 5,0/6,0 / 8,0 cm
- waterproof adhesive butyl seal

### DIMENSIONI / DIMENSIONS :

X	Y	H
80	80	4
100	100	4
120	120	4
140		4
160		5
180		5
200		5
220		5
240		5

### PESI / WEIGHTS :

piatto doccia:	5,90 kg/m <sup>2</sup>
shower tray:	5,90 kg/m <sup>2</sup>
bordo:	1,20 kg/ml
edge:	1,20 kg/lm

X - Y a misura su richiesta / bespoke upon request  
Y a richiesta fino a 150 cm / Y on request up to 150 cm

### COLLANTI / GLUES :

MAPEI KERALASTIC / KERAKOLL H40 EXTREME o similari  
direttamente su technoPVC / directly on the technoPVC.

Nel caso si utilizzino collanti diversi o rivestimenti in cemento-resina è necessaria l'applicazione di Primer.  
In case different glues are used or cement/resin claddings are applied, the use of a Primer is mandatory.

### PER INFORMAZIONI DI POSA VEDERE SCHEDA DI INSTALLAZIONE.

Should you need any information about the products' installation, please rely on the instructions provided

ATTENZIONE: Collaudare il piatto doccia prima della posa dei rivestimenti/resinatura.  
CAREFULL: Test the shower tray before laying the finishing/resin.

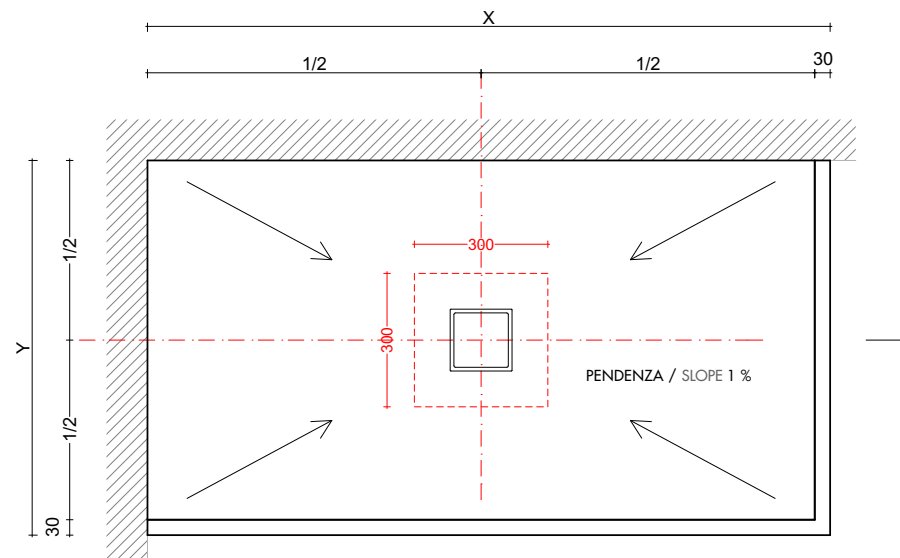

PILETTA SIFONATA H 60 mm / ingombro totale 65 mm -- portata 24 lt/min

WASTE WITH SIPHON H 60 mm / total height 65 mm -- flow rate 24 lt/min

PILETTA SIFONATA H 80 mm / ingombro totale 85 mm -- portata 31 lt/min

WASTE WITH SIPHON H 80 mm / total height 85 mm -- flow rate 31 lt/min

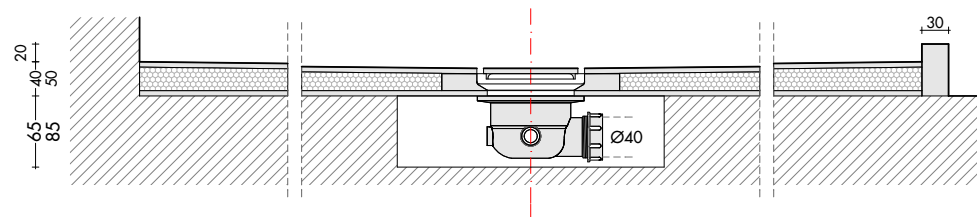

PILETTA SIFONATA H 50 mm (sifone ridotto) / ingombro totale 55 mm -- portata 31 lt/min

WASTE WITH SIPHON H 50 mm (reduced siphon) / total height 55 mm -- flow rate 31 lt/min

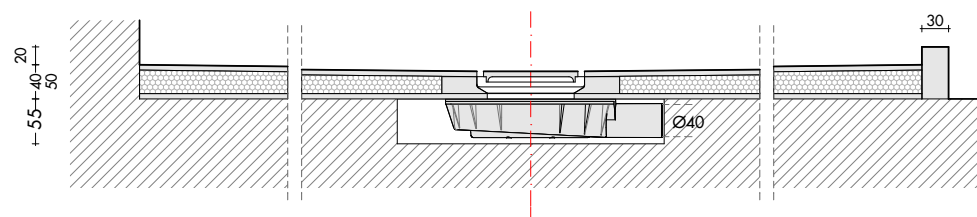

# BASIC SHOWER PLUS\_Appoggio Floorstanding

## 2 bordi tipo B 2 edges type B

Piatto doccia da rivestire in technoPVC

Showertray to be clad in technoPVC

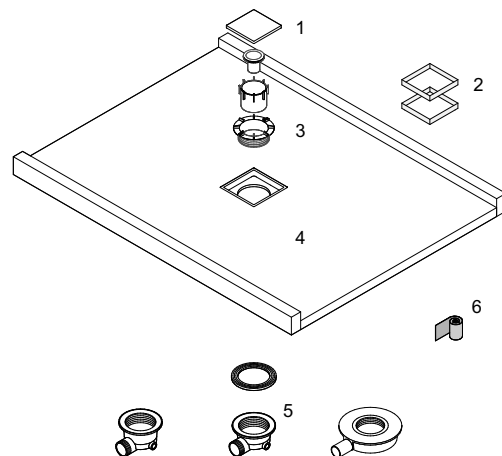

- 1 copriscarico in technoPVC standard
- 2 copriscarico in acciaio inox (opz.)
- 3 ghiera fissaggio piletta
- 4 basic shower
- 5 piletta h. 5,0/6,0/8,0 cm
- 6 nastro impermeabile butilico adesivo

- waste cover in technoPVC standard
- waste cover in stainless steel
- waste fixing ring
- basic shower
- waste H 5,0/6,0 / 8,0 cm
- waterproof adhesive butyl seal

### DIMENSIONI / DIMENSIONS :

X	Y	H
80	80	4
100	100	4
120	120	4
140		4
160		5
180		5
200		5
220		5
240		5

### PESI / WEIGHTS :

piatto doccia: 5,90 kg/m<sup>2</sup>  
shower tray: 5,90 kg/m<sup>2</sup>

bordo: 1,20 kg/ml  
edge: 1,20 kg/lm

X - Y a misura su richiesta / bespoke upon request  
Y a richiesta fino a 150 cm / Y on request up to 150 cm

### COLLANTI / GLUES :

MAPEI KERALASTIC / KERAKOLL H40 EXTREME o similari  
direttamente su technoPVC / directly on the technoPVC.

Nel caso si utilizzino collanti diversi o rivestimenti in cemento-resina è necessaria l'applicazione di Primer.  
In case different glues are used or cement/resin claddings are applied, the use of a Primer is mandatory.

### PER INFORMAZIONI DI POSA VEDERE SCHEDA DI INSTALLAZIONE.

Should you need any information about the products' installation, please rely on the instructions provided

ATTENZIONE: Collaudare il piatto doccia prima della posa dei rivestimenti/resinatura.  
CAREFULL: Test the shower tray before laying the finishing/resin.

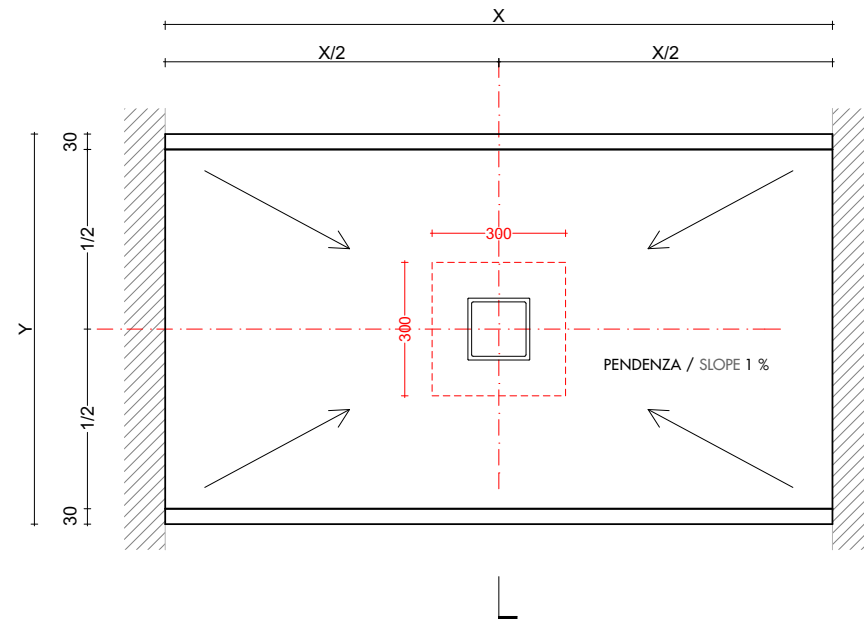

PILETTA SIFONATA H 60 mm / ingombro totale 65 mm -- portata 24 lt/min

WASTE WITH SIPHON H 60 mm / total height 65 mm -- flow rate 24 lt/min

PILETTA SIFONATA H 80 mm / ingombro totale 85 mm -- portata 31 lt/min

WASTE WITH SIPHON H 80 mm / total height 85 mm -- flow rate 31 lt/min

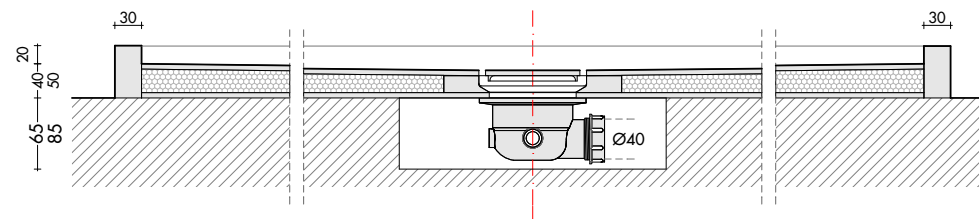

PILETTA SIFONATA H 50 mm (sifone ridotto) / ingombro totale 55 mm -- portata 31 lt/min

WASTE WITH SIPHON H 50 mm (reduced siphon) / total height 55 mm -- flow rate 31 lt/min

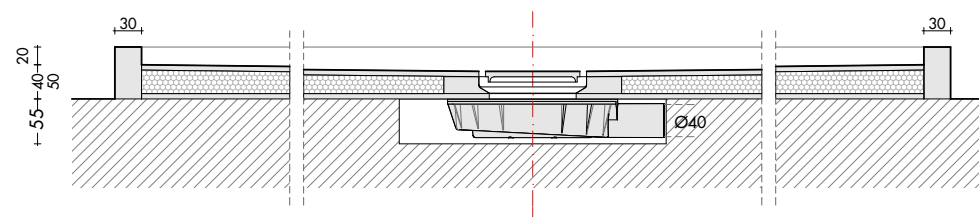

# BASIC SHOWER PLUS\_Appoggio Floorstanding

## 3 bordi tipo B 3 edges type B

Piatto doccia da rivestire in technoPVC

Showertray to be clad in technoPVC

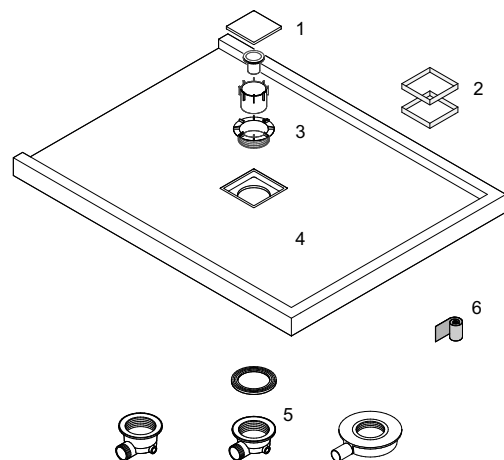

- 1 copriscarico in technoPVC standard
- 2 copriscarico in acciaio inox (opz.)
- 3 ghiera fissaggio piletta
- 4 basic shower
- 5 piletta h. 5,0/6,0/8,0 cm
- 6 nastro impermeabile butilico adesivo

- waste cover in technoPVC standard
- waste cover in stainless steel
- waste fixing ring
- basic shower
- waste H 5,0/6,0 / 8,0 cm
- waterproof adhesive butyl seal

### DIMENSIONI / DIMENSIONS :

X	Y	H
80	80	4
100	100	4
120	120	4
140		4
160		5
180		5
200		5
220		5
240		5

### PESI / WEIGHTS :

piatto doccia:	5,90 kg/m <sup>2</sup>
shower tray:	5,90 kg/m <sup>2</sup>
bordo:	1,20 kg/ml
edge:	1,20 kg/lm

X - Y a misura su richiesta / bespoke upon request  
Y a richiesta fino a 150 cm / Y on request up to 150 cm

### COLLANTI / GLUES :

MAPEI KERALASTIC / KERAKOLL H40 EXTREME o similari  
direttamente su technoPVC / directly on the technoPVC.

Nel caso si utilizzino collanti diversi o rivestimenti in cemento-resina è necessaria l'applicazione di Primer.  
In case different glues are used or cement/resin claddings are applied, the use of a Primer is mandatory.

### PER INFORMAZIONI DI POSA VEDERE SCHEDA DI INSTALLAZIONE.

Should you need any information about the products' installation, please rely on the instructions provided

ATTENZIONE: Collaudare il piatto doccia prima della posa dei rivestimenti/resinatura.  
CAREFULL: Test the shower tray before laying the finishing/resin.

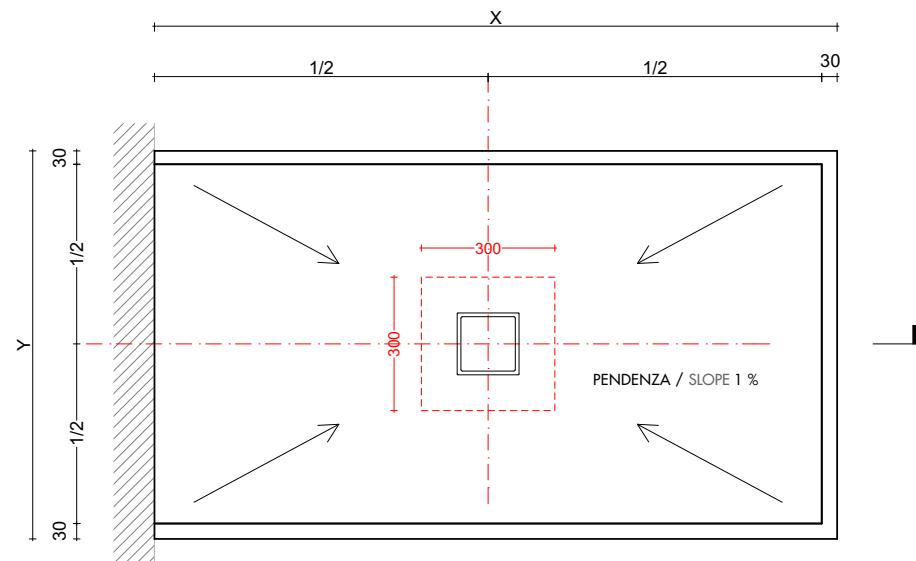

PILETTA SIFONATA H 60 mm / ingombro totale 65 mm -- portata 24 lt/min

WASTE WITH SIPHON H 60 mm / total height 65 mm -- flow rate 24 lt/min

PILETTA SIFONATA H 80 mm / ingombro totale 85 mm -- portata 31 lt/min

WASTE WITH SIPHON H 80 mm / total height 85 mm -- flow rate 31 lt/min

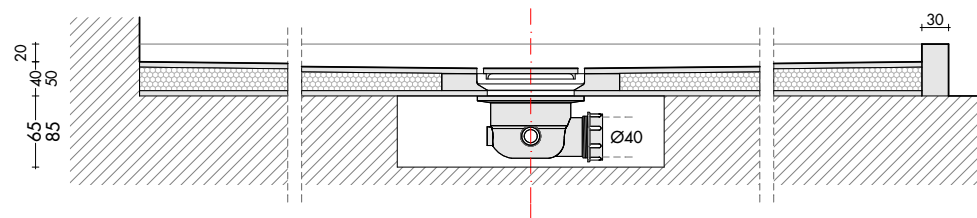

PILETTA SIFONATA H 50 mm (sifone ridotto) / ingombro totale 55 mm -- portata 31 lt/min

WASTE WITH SIPHON H 50 mm (reduced siphon) / total height 55 mm -- flow rate 31 lt/min

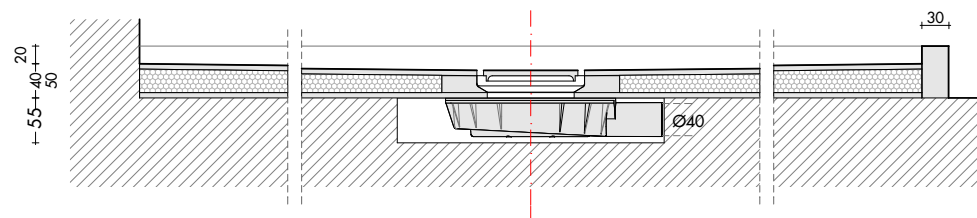

# BASIC SHOWER PLUS\_Appoggio Floorstanding

## 4 bordi tipo B 4 edges type B

Piatto doccia da rivestire in technoPVC

Showertray to be clad in technoPVC

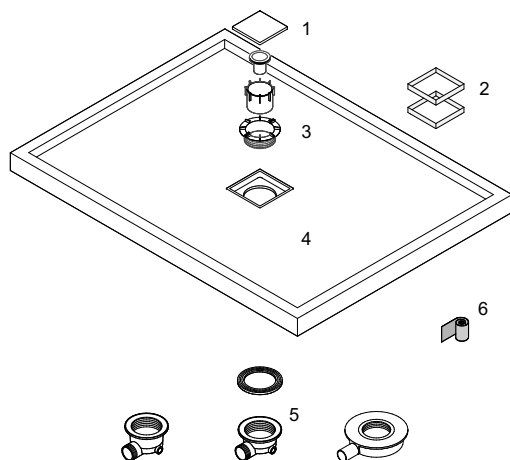

- 1 copriscarico in technoPVC standard
- 2 copriscarico in acciaio inox (opz.)
- 3 ghiera fissaggio piletta
- 4 basic shower
- 5 piletta h.5,0/6,0/8,0cm
- 6 nastro impermeabile butilico adesivo

- waste cover in technoPVC standard
- waste cover in stainless steel
- waste fixing ring
- basic shower
- waste H 5,0/6,0 / 8,0 cm
- waterproof adhesive butyl seal

### DIMENSIONI / DIMENSIONS :

X	Y	H
80	80	4
100	100	4
120	120	4
140		4
160		5
180		5
200		5
220		5
240		5

### PESI / WEIGHTS :

piatto doccia: 5,90 kg/m<sup>2</sup>  
shower tray: 5,90 kg/m<sup>2</sup>

bordo: 1,20 kg/ml  
edge: 1,20 kg/lm

X - Y a misura su richiesta / bespoke upon request  
Y a richiesta fino a 150 cm / Y on request up to 150 cm

### COLLANTI / GLUES :

MAPEI KERALASTIC / KERAKOLL H40 EXTREME o similari  
direttamente su technoPVC / directly on the technoPVC.

Nel caso si utilizzino collanti diversi o rivestimenti in cemento-resina è necessaria l'applicazione di Primer.  
In case different glues are used or cement/resin claddings are applied, the use of a Primer is mandatory.

### PER INFORMAZIONI DI POSA VEDERE SCHEDA DI INSTALLAZIONE.

Should you need any information about the products' installation, please rely on the instructions provided

ATTENZIONE: Collaudare il piatto doccia prima della posa dei rivestimenti/resinatura.  
CAREFULL: Test the shower tray before laying the finishing/resin.

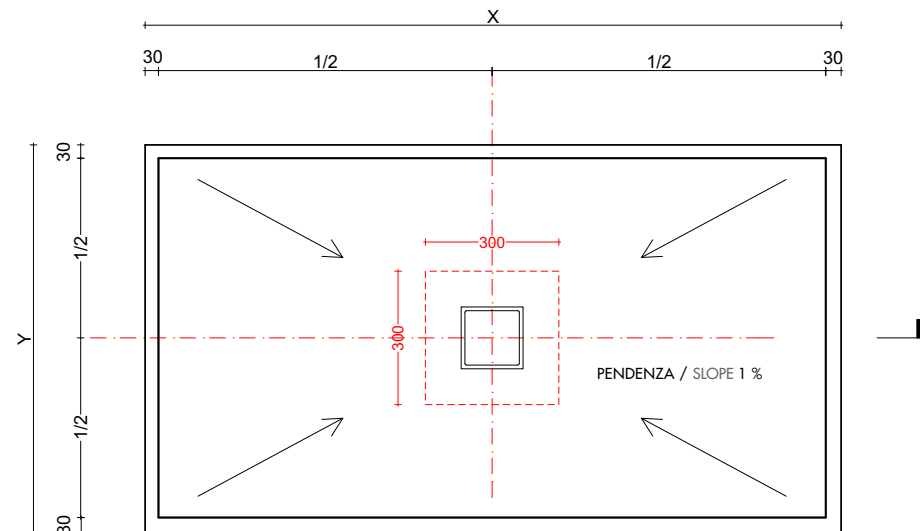

PILETTA SIFONATA H 60 mm / ingombro totale 65 mm -- portata 24 lt/min  
WASTE WITH SIPHON H 60 mm / total height 65 mm -- flow rate 24 lt/min

PILETTA SIFONATA H 80 mm / ingombro totale 85 mm -- portata 31 lt/min  
WASTE WITH SIPHON H 80 mm / total height 85 mm -- flow rate 31 lt/min

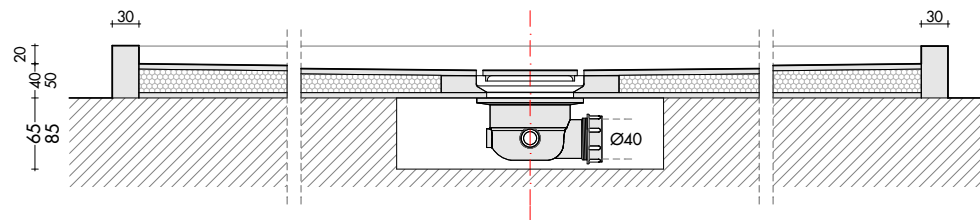

PILETTA SIFONATA H 50 mm (sifone ridotto) / ingombro totale 55 mm -- portata 31 lt/min  
WASTE WITH SIPHON H 50 mm (reduced siphon) / total height 55 mm -- flow rate 31 lt/min

